



A Project by



LIVE A SIGNATURE LIFE



2 & 3 BHK Luxury Apartments @ Hanamkonda, Warangal.

A Signature Project from SREEMAAVI INFRA PVT. LTD.

ARCHITECTS



Flat # 12B, Buckingham, (Amrutha valley)
Road no-12 Banjara hills, Hyderabad.
9494439837, 040-23386969.
www.gsstudiodesignconsultants.in

STRUCTURAL



#2nd Floor, Vaishnavi Double Ten,
Madhapur, Hyderabad - 500 081.
Call: 040 - 23374888, 9866662164.
E_mail: id.samparka@gmail.com

LANDSCAPE ARCHITECTS



Flat. No. 402, Environ Krishna Classic,
Sai Aishwarya Layout, Khajaguda, Hyd - 89
mail: tejaassociates86@gmail.com

MEP CONSULTANTS



UNITE SERVICE CONSULTANTS INDIA PVT LTD
#551, 2nd Floor, 60 Feet Road, AECS layout,
A- Block, Kudlu, Bangalore - 560 068

PROJECT CONSULTANTS



24-7-266/2, Ramakrishna Colony, Subedari,
Hanamkonda, Warangal - 506 004
Call: +91 9650 2696 04, 8826 8728 66

BRANDING & DESIGN



Ayyappa Society, Madhapur, Hyd.
Contact: 9989 11 9900, 9989 70 99 66.
E_mail: info.kreadz@gmail.com.

TEAM

OWN THE
FINEST ADDRESS &
EXPERIENCE PRIDE



YOU ASPIRED FOR A BEAUTIFUL LIVING
WELCOME TO A WAY OF LIFE



FEEL ARRIVED.
FEEL BELONGED.
FEEL CONNECTED.
FEEL GOOD ABOUT IT ALL.

From an exceptional architectural style to innumerable pockets of open spaces and compelling aesthetic elements to enviable array of leisurely amenities, there's a lot to cheer about at SREEMAAVI SIGNET.

A sign of welcome, the double-height gates are more than mere entrance and exit points they are gateways to an all-inclusive lifestyle.





LIVE IN BLISS
EXPERIENCE LUXURY

SREEMAAVI SIGNET is a creation that encapsulates aspirations, lifestyle, luxuries and several other attributes that come together to fulfill ambitions and dreams of several home-seekers. Come make your way in, to a world that's as large as a warm-heart, waiting to welcome many a dream, many a desire, and many a wonderful families. Make yourself part of a life where you can explore more, always.

A CLASS APART LIFESTYLE,
WE CALL IT THE CONDO LIFE



LEGEND

- | | | |
|-----------------------|--------------------------|--------------------------|
| 1. Entry & Exit Gate | 6. Pool Deck | 11. Swimming Pool |
| 2. Pedestrian Pathway | 7. Lawn | 12. Party Lawn |
| 3. Car Parking | 8. Elders Sitout Area | 13. Seating Plaza |
| 4. Jogging Track | 9. Fitness Station | 14. Designer Landscaping |
| 5. Kid's Pool | 10. Children's Play Area | |





8'-0" wide corridor

8'-0" wide corridor

8'-0" wide corridor

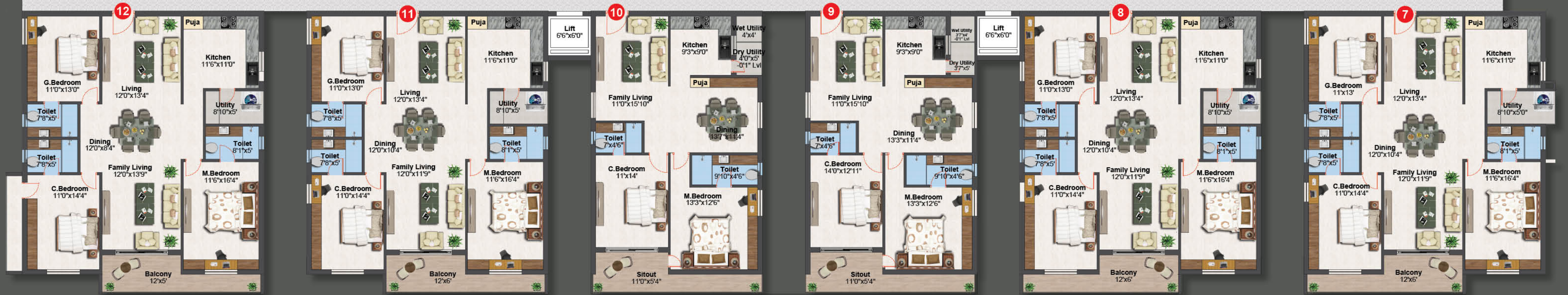

AREA STATEMENT

Flat No.	1	2	3	4	5	6	7	8	9	10	11	12
Unit	3 BHK	3 BHK	3 BHK	3 BHK	3 BHK	3 BHK	3 BHK	3 BHK	2 BHK	2 BHK	3 BHK	3 BHK
Plinth Area in Sft.	1504	1448	1448	1448	1448	1504	1608	1568	1116	1116	1568	1600
Common Area in Sft.	376	362	362	362	362	376	402	392	279	279	392	400
Super Builtup Area in Sft.	1880	1810	1810	1810	1810	1880	2010	1960	1395	1395	1960	2000

BLOCK - A | TYPICAL FLOOR PLAN





REFINED AMBIENCE THAT SPEAKS OF STYLE AND CLASS



8'-0" wide corridor

8'-0" wide corridor

8'-0" wide corridor

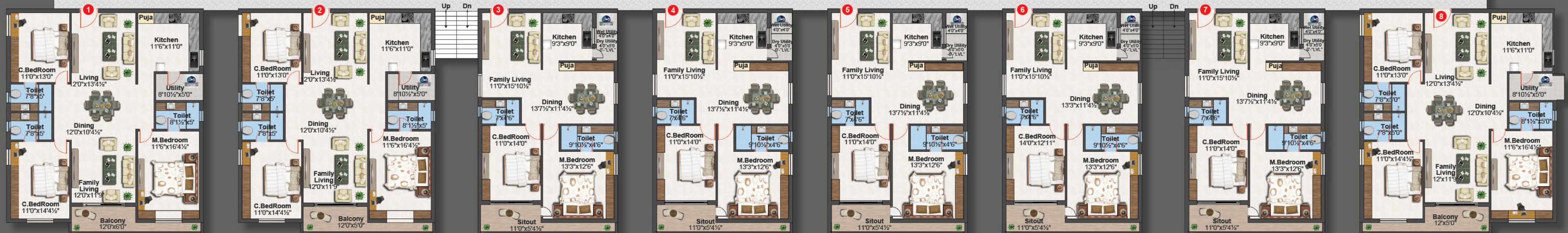

BLOCK - B | TYPICAL FLOOR PLAN



AREA STATEMENT

Flat No.	1	2	3	4	5	6	7	8	9	10	11	12	13
Unit	3 BHK	3 BHK	2 BHK	2 BHK	2 BHK	2 BHK	2 BHK	3 BHK	2 BHK	2 BHK	2 BHK	2 BHK	2 BHK
Plinth Area in Sft.	1600	1568	1116	1116	1116	1116	1116	1608	972	1116	1116	1116	1160
Common Area in Sft.	400	392	279	279	279	279	279	402	243	279	279	279	290
Super Builtup Area in Sft.	2000	1960	1395	1395	1395	1395	1395	2010	1215	1395	1395	1395	1450



Your home should become the most special place in your heart. Whether it is for its aesthetics, design and beauty, for the standard of amenities it provides, or just for the reason that it looks quite welcoming every time you make your way under its arch. SREEMA AVI SIGNET has all the qualities to tick these boxes. And it starts with its wide, vast and inviting archway that welcomes you into its majestic lap, which is as endearing as a warm welcome.

ENLIVEN EVERY MOMENT
EXPERIENCE AN EXTRAVAGANZA



SIGNET
RESIDENCIAL

SIGNET
RESIDENCIAL



A CLASS APART LIFESTYLE,
WE CALL IT THE CONDO LIFE



S
SREEMA VI
SIGNET
REDIFINING LUXURY



OWN THE
FINEST ADDRESS &
EXPERIENCE PRIDE





3 BHK

EASTVIEW

LIVING SPACE

Entrance, Drawing, Dining, Balcony

KITCHEN SYSTEM

Kitchen, Wash Area, Utility

BEDROOMS

M. Bedroom + Toilet, G. Bedroom + Toilet
C. Bedroom + Toilet



3 BHK

WEST VIEW

LIVING SPACE

Entrance, Drawing, Dining, Balcony

KITCHEN SYSTEM

Kitchen, Wash Area, Utility

BEDROOMS

M. Bedroom + Toilet, G. Bedroom + Toilet
C. Bedroom + Toilet



2 BHK

WEST VIEW

LIVING SPACE

Entrance, Drawing, Dining, Balcony

KITCHEN SYSTEM

Kitchen, Wash Area, Utility

BEDROOMS

M. Bedroom + Toilet, C. Bedroom + Toilet



2 BHK

EAST VIEW

LIVING SPACE

Entrance, Drawing, Dining, Balcony

KITCHEN SYSTEM

Kitchen, Wash Area, Utility

BEDROOMS

M. Bedroom + Toilet, C. Bedroom + Toilet

FOR DREAMS OF
EVERY DIMENSION



SITE DELIGHTS

- * Exclusive 123 Dwelling Units
- * Huge Lavish Sit-outs
- * Wide corridors for increased Privacy
- * All Flats equipped with AC Ducting
- * Round the clock CCTV Surveillance
- * 12,000 Sft Club House
- * Spacious 2 & 3 BHK flats Ranging from 1395 Sft to 2010 Sft.
- * Infinity swimming pool
- * Well-equipped Gymnasium
- * Sewerage Treatment Plant for reuse of water for Flushing and Landscaping
- * Hydro-Pneumatic Pressurized Water Supply
- * Solar Fencing along the Compound wall
- * One Covered Car Parking per Residence
- * 100% Power Backup for all Apartments except A/C's and Geysers

A LUXURIOUS
TREAT OF LEISURE



AMENITIES & FEATURES

Multipurpose Hall for get-togethers	Provision for an ATM
Waiting Lounge	Provision for a Salon
Guests Rooms	Provision for a Pharmacy
Walking and Jogging Tracks	Provision for a Super Market
Children Play Area	Provision for a Cafeteria with Kitchen
Multi-Purpose Court for Outdoor Games	Covered Pool with Temperature Controlled facility.

There is an independent, exclusive Clubhouse for the residents of SREEMA AVI SIGNET. It's an aesthetic space of over 12,000 square feet and planned with a plethora of entertainment and fitness facilities. The icing on cake is the laving rooftop Swimming Pool with a chilled-out seating deck. Summers will be full of enjoyment once you move in here.

Whether you want to play, relax, meditate or just meet up with friends, this is a sublime spot.



The uncertainties of life put us through a mix of several moments. Some of them we are delighted by, some of them we welcome with a warm heart, some others we desperately await, some of them fulfill our dreams, some others happen once-in-a-lifetime. But the best ones are those that we never expected. SREEMA AVI SIGNET is your gateway to those moments. And here's a place that is designed to welcome those moments for the rest of your life So it would only be apt to say, come on in, your moment has arrived.



SPECIFICATIONS



STRUCTURE

R.C.C. Frame structure is designed to the standard specification of 'Bureau of Indian Standards' with due provisions for earthquake force and self-bearing capacity of strata.



FOUNDATION

Piles / Raft laid on hard gravelly soil and sheet rock. The slabs shall be built with 'Ready Mix' Concrete, under strict control with rich concrete proportion of M20 & M25 grades with steel of reputed make.



SUPER STRUCTURE

Light Brick masonry with Red bricks or Solid Cement Aerated Concrete Blocks a) Outside Wall of 9" thick b) Internal Wall of 4.5" thick.



PLASTERING

Joint of the R.C.C. structure & Brick wall will be covered with mesh before internal wall plastering commences. External & Internal wall double coat cement plaster with smooth finish.



DOORS

Teak Wood frame or Factory-made Wooden frames with Laminated Flush shutter, UPVC frame, shutters styles and rails with float plain glass panel shutters & designer hardware of reputed make.



WINDOWS

UPVC window frames, shutters in glass panels and mesh shutter, fitted with elegantly designed MS enamel painted grills and standard hardware.



PAINTING

Paint will be of Asian/Nerolac/Dulux or equivalent make. Smooth finish with two coats of lappam/putty, two coats of acrylic emulsion paint over a coat of primer.



TOILETS

Consists of wash basin of Jaguar / CERA / Parryware / Hindware or equivalent make. Wall Hung EWC of or equivalent make.



FLOORING AND WALL TILING

Twin Charged Vitrified tiles in size of 800mm x 800mm & skirting of reputed make. Wooden floor ceramic tile in the master bedroom.



KITCHEN

Dry and wet. Glazed ceramic tiles 800mm x 800mm dado up to 2' height above granite platform with stainless steel sink & drain board. One tap for the inlet for RO process equipment & other tap for bore well water supply.



TOILET FITTINGS

Hot & Cold diverter with Overhead Shower and Spout. Provision for Geysers in all Toilets. All C.P. Fittings are Chrome plated of CERA / Parryware / Hindware / Jaquar or equivalent make. Shower enclosure to separate the Dry and Wet area.



BACK-UP GENERATOR

Standby generator for light in common area, lift and pumps 0.5 KVA power backup to each apartment.



LIFTS

6 passenger automatic and make will be Johnson / Kone or equivalent.



ELECTRICAL

Concealed Copper wiring in conduits for Lights, fans, Plug & Power plug points wherever necessary of FRLS Finolex / Havells / Anchor or equivalent make. Modular switches of Havells / Legrand / Anchor or equivalent make.



NOTE

1. Registration charges, GST and any other taxes applicable as per government norms to be borne by customer only.
2. People desiring to alter/modify their flat can do so by prior request and additional payment
3. Cement racks, arch, etc. optional with extra cost.
4. Flat will be handed over for wood work / interiors after receiving 100% payment only.

LOCATION MAP
(Not to scale)



Scan QR for Location



PROXIMITY

- DPS Primary - 01 mins
- NIT (Warangal) - 02 mins
- Tejaswi High School - 03 mins
- Hanamkonda Dist. Collectorate - 03 mins
- Officer's Club - 03 mins
- Adalath Circle - 05 mins
- Rohini Super Speciality Hosp - 05 mins
- Sri Krishna Children's Hosp - 06 mins
- Adalath Circle - 07 mins
- Kakatiya University - 10 mins
- Kazipet Rly. Station. - 10 mins
- Hanmakonda Circle - 10 mins
- Zoological Park - 10 mins
- Asian Multiplex - 10 mins
- Badrakali Temple - 15 mins
- Ajara Super Speciality Hosp - 15 mins



Approved Gated Community

BUILT BY THOSE WITH
A PASSION FOR LIVING

Completed Project
Sreemaavi Lake Meadows



Ongoing Project
Sreemaavi Opulence



Up Coming Project
Sreemaavi Solitaire



Project Developed by



Spellbound Towers, Level - 3, Hi-Tension 'X' Roads,
Sainikpuri, Secunderabad, Hyderabad, Telangana State - 500 094.

Email: Info@sreemaavi.com, www.sreemaavi.com

Site Address: SREEMAABI SIGNET, Near Sri Venkateshwara Temple,
Chaitanyapuri, Hanamkonda - 506 001.

Ph: 92 777 99999, 76 774 99999



SREEMAVI INFRA PVT. LTD.

Spellbound Towers, Level - 3, Hi-Tension X Roads,
Sainikpuri, Secunderabad - 500 094.